

# BRAEMORE PARK

## APPROVED SCREENED PORCHES & FENCING

### SCREENED PORCHES

Buyers shall be permitted to convert their covered patios into screened porches. In order to maintain the consistency of the neighborhood and maintain design integrity, the following specifications must be met for screened porch approval:

- Trim of screened porch is to be 1/2" x 2" aluminum frame or smaller.
- Door of screened porch is to also be of the same color and material as the frame.
- There shall be no railing or kick plate installed at the bottom of the screen other than a single rail as pictured below.
- Screen shall be 1814 mesh.

Examples of acceptable screen enclosures are pictured below.



### **Approved vendors for screened enclosures are:**

Leon Screening & Repair: 850-575-2840

All About Gutters: 850-445-4463

# BRAEMORE PARK



## APPROVED SCREENED PORCHES & FENCING

### FENCING

As a part of the development of the community, certain areas for each homeowner have been deemed "Limited Common Elements". This space may be used as a fenced enclosure should you choose to do so. Below are examples of approved fencing and also a layout depicting each homes allowable space.



#### HATCH LEGEND

	LIMITED COMMON AREA
	HOA ACCESS AND DRAINAGE EASEMENT
	10' PASS THROUGH EASEMENT TO TALLAHASSEE NURSERY PARCEL

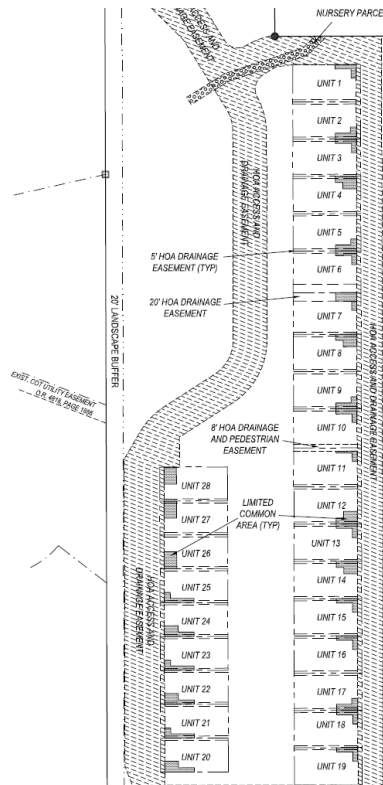

*Please refer to the recorded documents for more detailed and complete site survey.*